

**48HR TANK
TD550, TD600
VD600**

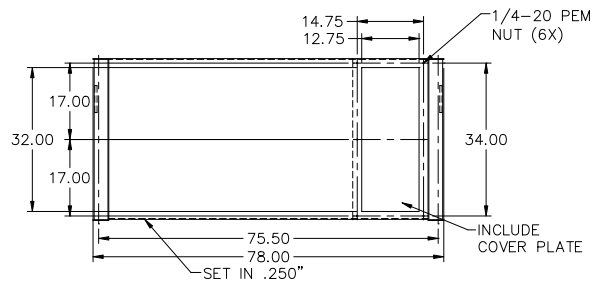
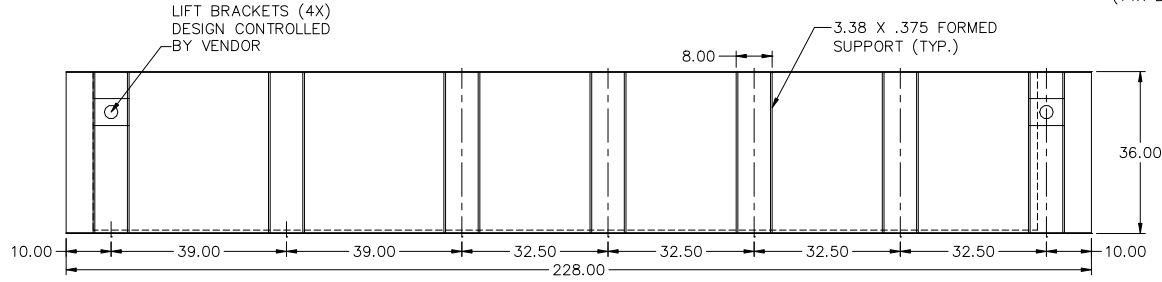
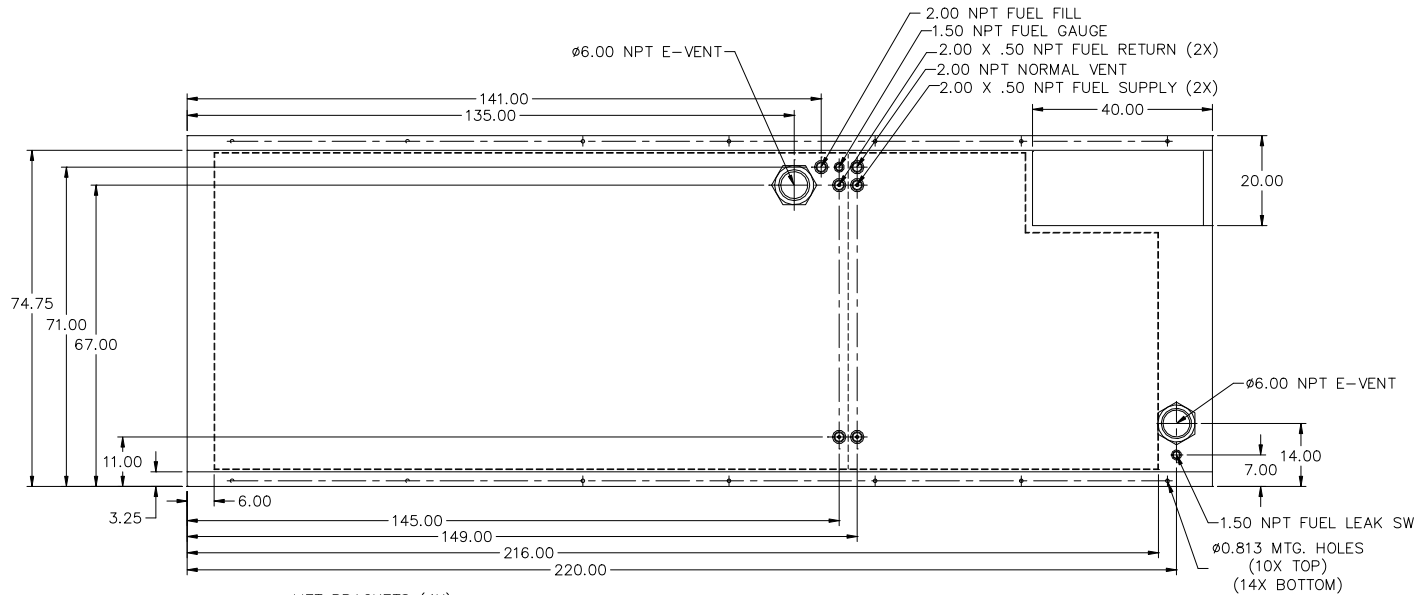

APPROXIMATE WEIGHT: 4100LBS

- NOTES:
1. MATERIAL: 7GA. RUPTURE BASIN
10GA. INNER TANK
 2. SECONDARY CONTAINMENT TANK
 3. FINISH PAINT GLOSS BLACK
 4. TANK TO INCLUDE
 - FUEL SUPPLY / RETURN DIP TUBES
 - LIFTING / TIE DOWN BRACKETS

REVISIONS:			
LEVEL:	DESCRIPTION:	DATE:	BY:
1	ADJUSTED FOR TD550, TD600 & VD600	12-30-15	KDH

BLUE STAR
Power Systems Inc.

TANK SB 2000GL DW UL W/STUB-UP

P/N: 19426	228"L X 78"W X 36"H
DATE: 12-03-15	BY: KAP DRAWN TO SCALE