

48HR TANK  
MD800, MD1000  
LV3

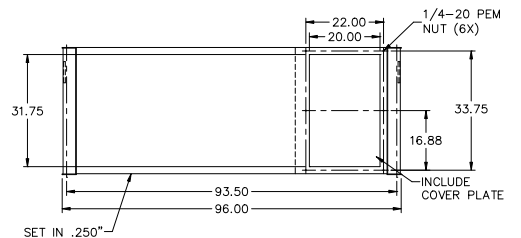
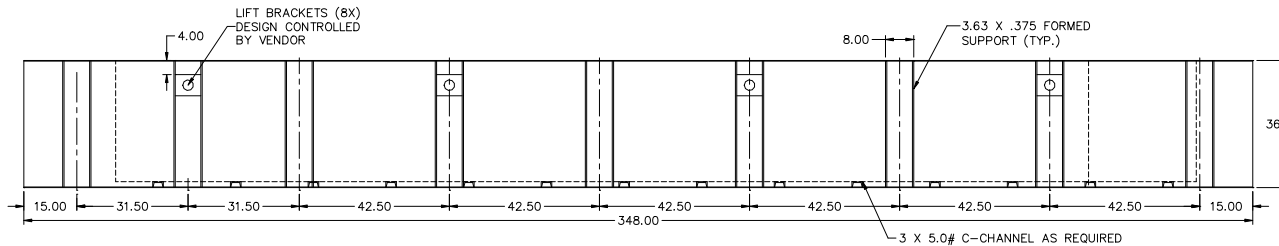
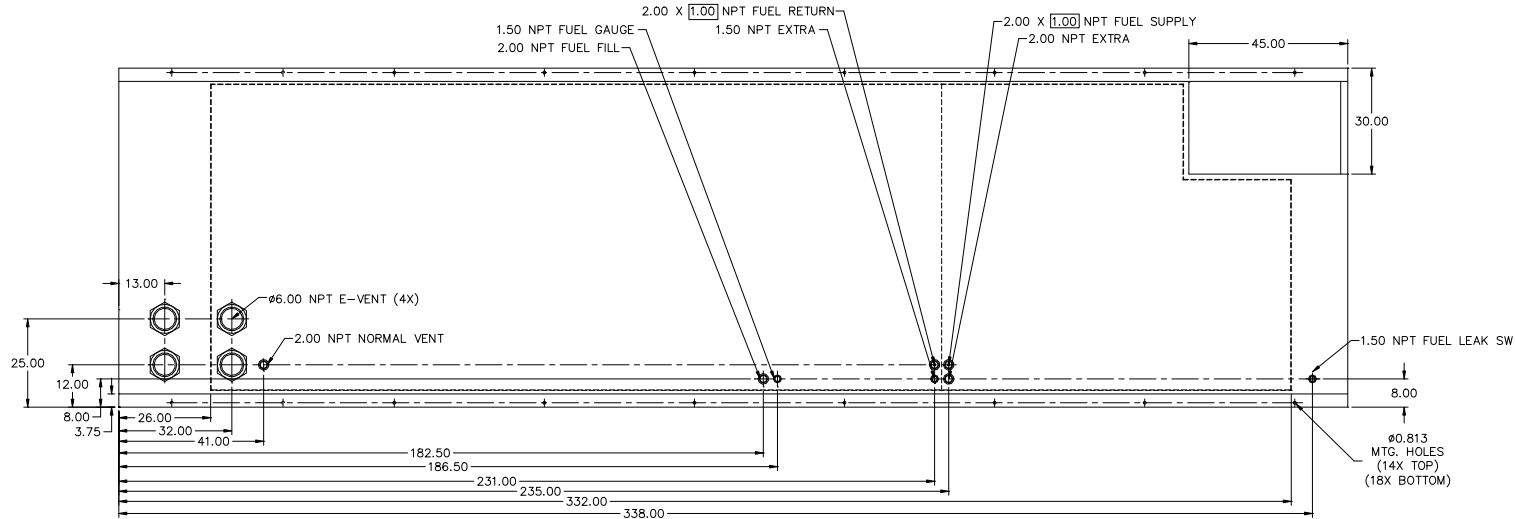

NOTES:

1. MATERIAL: 7GA. RUPTURE BASIN  
7GA. INNER TANK
2. SECONDARY CONTAINMENT TANK
3. FINISH PAINT GLOSS BLACK
4. TANK TO INCLUDE
  - FUEL SUPPLY / RETURN DIP TUBES
  - LIFTING / TIE DOWN BRACKETS
5. FUEL NPT SUPPLY/RETURN 2.00 X 1.00

APPROXIMATE WEIGHT: 9000 LBS

REVISIONS:

LEVEL:	DESCRIPTION:	DATE:	BY:
01	MOVE FITTINGS TO STANDARDIZE LOCATIONS, MATERIAL	07-15-16	KAP

**BLUE STAR**  
Power Systems Inc.

TANK SB 3600GL DW UL W/STUB-UP

P/N: 19727 348"L X 96"W X 36"H

DATE: 07-15-16 BY: KDH DRAWN TO SCALE