

**72HR TANK  
TD350,TD400  
VD350, VD400 (FT4)  
PD350,PD400  
LV0/LV1/LV2/LV3**

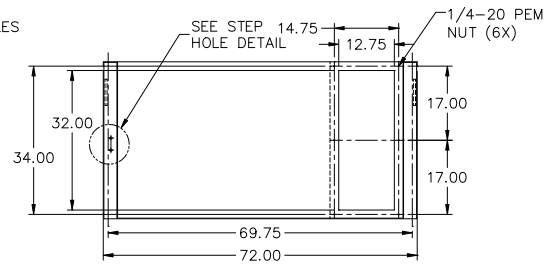
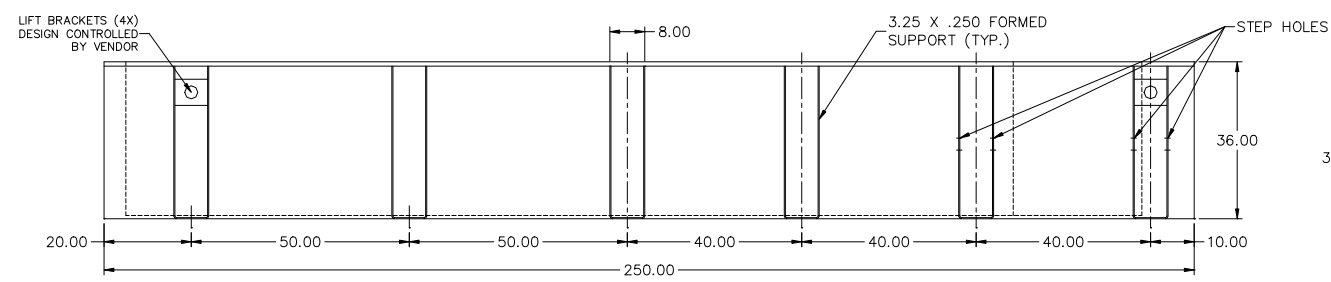
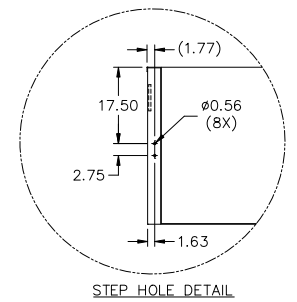
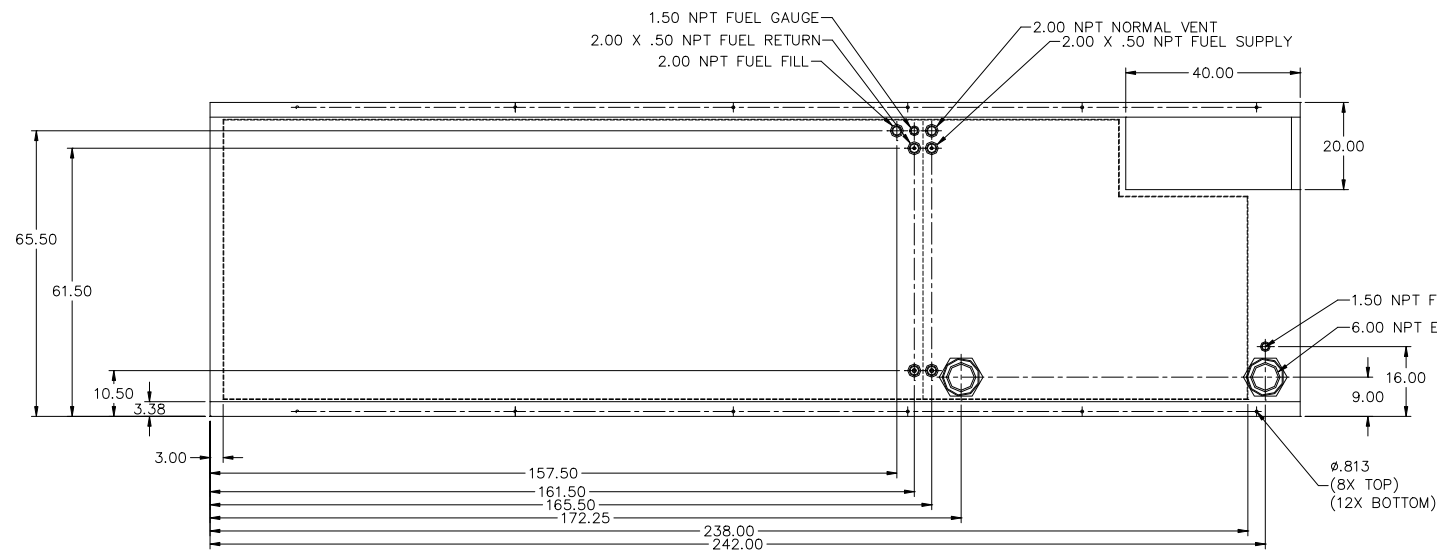

- NOTES:  
1. MATERIAL: 7GA. OUTSIDE  
7GA. INSIDE  
2. SECONDARY CONTAINMENT TANK  
3. FINISH PAINT GLOSS BLACK  
4. TANK TO INCLUDE  
- FUEL SUPPLY / RETURN DIP TUBES  
- LIFTING / TIE DOWN BRACKETS

APPROXIMATE WEIGHT: 5600 LBS

REVISIONS:			
LEVEL:	DESCRIPTION:	DATE:	BY:
03	ADDED ULC TO DESCRIPTION	02-17-20	MGH
02	MOVE E-VENT	07-05-17	KAP
01	ADD PN TO DRAWING - UPDATE DIMENSIONS	12-08-16	KAP



**TANK SB 2130 GL DW UL/ULC W/STUB-UP**

P/N: 20641 | 250"L X 72"W X 36"H

DATE: 07-05-17 | BY: KAP | DRAWN TO SCALE